

GX200

16"/40 cm

*Lightweight PPV Blower
with PowerStream® Technology*

Light weight gas powered ventilator with remarkable airflow! Weighing in at only 48 lbs (22kg), the GX200 can be easily carried up stairwells and into commercial buildings or set up for PPV in residential settings. The lightweight blower puts out an impressive 12,800 cfm (21,760 m³/hr) airflow, matching the performance of fans nearly twice its weight.

Equipped with PowerStream® air straighteners to produce a powerful, straight, focused beam of air; allowing the fan to be set back further from a structure's entrance without sacrificing PPV performance. The lightweight GX200 offers superior ventilation with less equipment clutter and reduced noise inside the structure.

Specifications

Model	GX200
Part	GG5010
Weight	48 lbs / 22 kg
Impeller	7-Blade
Dimensions (h/w/d)	21.5 x 19.5 x 20.5 in / 55 x 50 x 52 cm
Engine	Honda GXH50 2.1 Hp / 1.6 kW
Noise	91db@3' (1 m) / 86 dB@10' (3 m)
Run Time	1hr 40 min
Approval	CE

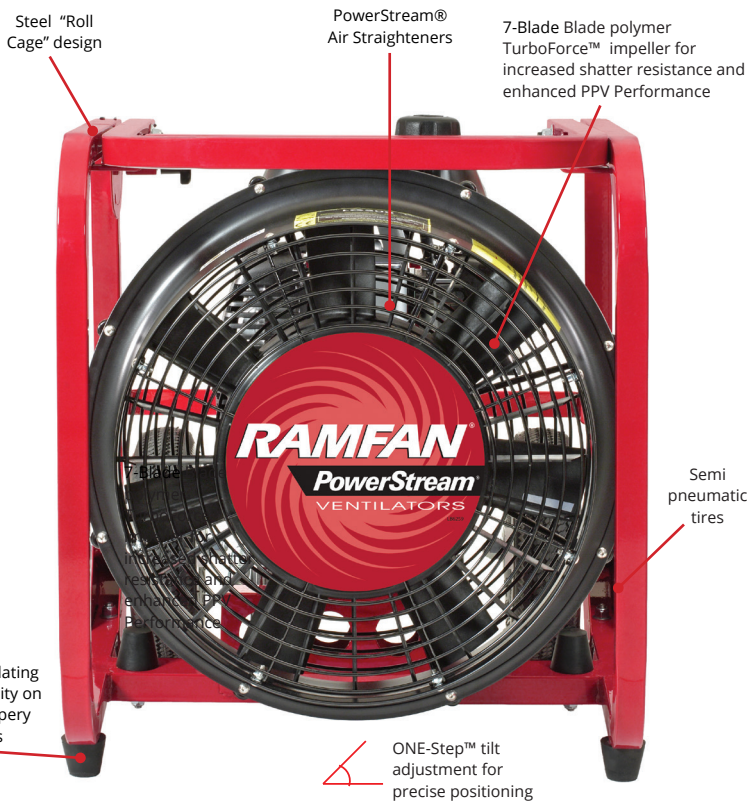

Vibration isolating feet for stability on hard or slippery surfaces

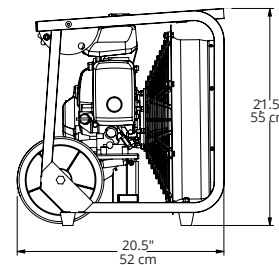
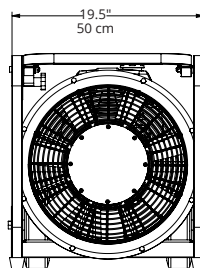

Performance

Airflow	
Opening Size (Single Door)	12,800 cfm 21,760 m³/hr

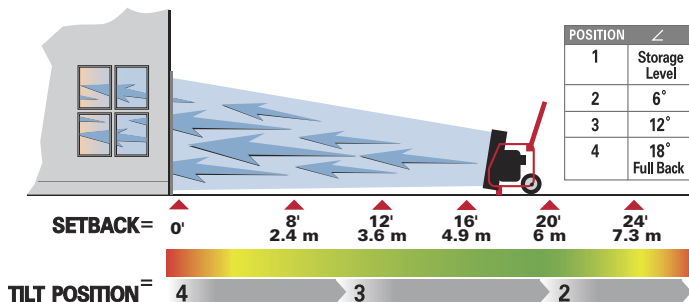

Available Accessories

BigBore™ Exhaust Diverter Adapter
Muffler Fitting
Order # GF7110-KZ



Exhaust Diverter Hose
2" x 12' (5 cm x 3.6 m)
Order # GF7115



Hour Meter
GX Series
Order # GX1515
Keep track of regular scheduled maintenance

