

## GF210

### 21"/54 cm

*Gas-Powered Ventilator*

Tried and true, tested and trusted, conventional ventilators have stood the test of time. The GF series are the PPV fans that helped to build the RAMFAN brand in the industry and these feconomical gas fans are well known for their durability.

Compact with outstanding close range ventilation using TurboForce™ technology to generate stronger, faster and more focused airflow than possible with conventional propeller designs. With the large amount of airflow, the fan is powerful enough to use for large structure ventilation.

### Specifications

<b>Model</b>	GF210
<b>Part</b>	GE5001
<b>Weight</b>	88 lbs / 40 kg
<b>Impeller</b>	7-Blade
<b>Dimensions (h/w/d)</b>	24.8 x 25.3 x 22.4 in / 63 x 64.3 x 22.4 cm
<b>Engine</b>	Honda GX160 4.8 Hp / 3.5 kW
<b>Noise</b>	96 dB@3' (1 m)
<b>Run Time</b>	1 hr 26 min
<b>Approval</b>	CE

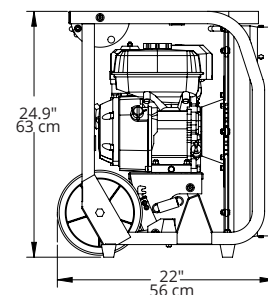
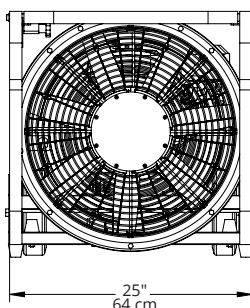
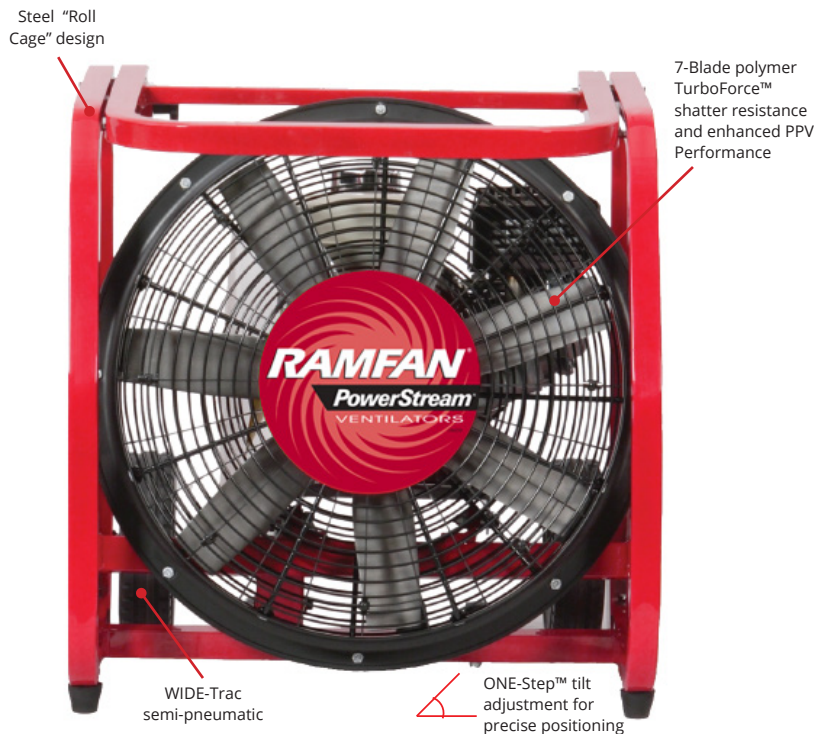

### Performance

<b>Airflow</b>	
Opening Size (Single Door)	17,670 cfm (30,039 m³/hr)

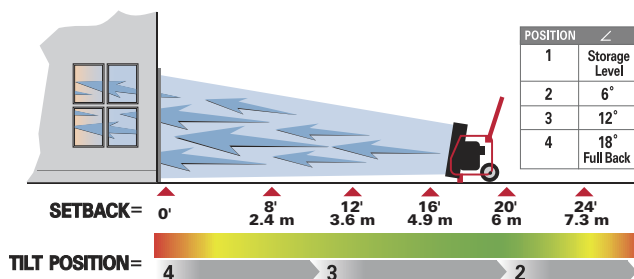

### Available Accessories

#### Integrated Misting System

1.85 gal/min @ 100 psi  
7 l/min @ 6.9 bar  
Order # GE8111

#### Exhaust Diverter Hose

2" x 12' (5 cm x 3.6 m)  
Order # GF7115

#### BigBore™ Exhaust Diverter Adapter

Muffler Fitting  
Order # GF7120-BZ  
Compatible with Honda motors

#### Hour Meter

GX Series  
Order # GX1515  
"Keep track of regular scheduled maintenance"



Integrated Misting System



BigBore™ Exhaust Diverter Adapter



Exhaust Diverter Hose



Hour Meter